



weinor

Premium quality  
Made in Germany



# Sottezza

Sottezza LED

[www.weinor.com](http://www.weinor.com)

Relax al Fresco |

**weinor**





## Contents

|                    |    |                             |    |
|--------------------|----|-----------------------------|----|
| Product highlights | 4  | Coupling units              | 13 |
| Sottezza models    | 6  | Cross-sections              | 14 |
| Awning fabrics     | 8  | Tensioning system           | 15 |
| Frame colours      | 8  | Planning/measuring          | 16 |
| Sottezza LED       | 10 | Sottezza fitted to Terrazza | 17 |
| Remote control     | 11 | Model designations          | 18 |
| Accessories        | 12 | Fixings                     | 19 |
| Manual operation   | 13 | Installation options        | 20 |



## weinor Sottezza – under-mounted roof awning with a cosy feel



The under-mounted Sottezza roof awning provides protection against glare with a cosy effect. Ideal as long as there is enough air circulation in the Glasoase® or beneath another type of glazed patio roof. Can also be used as a secondary sunshade for your roof, making effective use of the heat of the sun in the winter while at the same time keeping out glare. Though highly resilient, the Sottezza also has an attractive, slim design. Constructed to go perfectly with weinor patio roofs, the Sottezza can also be fitted to any square-shaped patio roof thanks to ultra-precise custom building.

## Sottezza highlights



47 frame colours  
and 9 trend colours



Attractive design

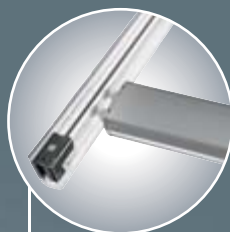

Innovative  
tensioning system



Precise  
carriage system



Easy-install unit



Sottezza LED  
version

## Product benefits in detail

Perfect protection against glare for well-ventilated patio roofs and Glasoase®: highlights of the under-mounted Sottezza roof awning



### Attractive design – slim and smart

This attractive, round cassette blends smartly into the architecture of the patio roof. At the same time, the round shape leaves space for the optional weinor LED light bar.

- little cassette overhang for maximum use of space
- slim side channels leave narrow gap in fabric (only about 40 mm)
- no screws visible



### Innovative tensioning system keeps fabric position well adjusted

The regular billows of fabric create a cosy atmosphere. This is all thanks to the simple, resilient tensioning system.

- fabric constantly kept uniformly taut using gas springs, automatically tightened into final position
- Tex-Seil rope using ocean sailing technology; quiet-running, tear-resistant, high tensile strength



### Precise carriage system – simple and quiet

The Sottezza carriage runs on rollers, meaning that the shade is very easy and quiet to extend.

- Tex-Seil rope precisely guided
- rolls up neatly
- firm positioning of carriage prevents jamming



### Easy-install unit – fits under any patio roof

The weinor Sottezza is particularly quick and easy to install.

- tensioned rope system pre-fitted: comes pre-threaded into front rail and end cap

- very easy to install onto a Terrazza
- also suitable for other manufacturers' aluminium, steel or wooden roofs



### Sottezza LED – dim LED lighting to any level with WeiTronic

The Sottezza LED creates atmospheric lighting under your patio roof. The light bar matches the colour of the Sottezza.

- 30,000 hours of lighting with minimal energy consumption
- extremely energy-efficient
- dim to any level with WeiTronic



- standard
- optional
- unavailable

## Sottezza roof awning versions

|   | Sottezza                         | Sottezza LED                     |
|---|----------------------------------|----------------------------------|
| <b>Technology</b>   |                                  |                                  |
| Max. width (distance between centre lines for 1 panel)                    | 600 cm                           | 600 cm                           |
| Max. distance between centre lines for multi-panel unit                   | see p. 16                        | see p. 16                        |
| Max. projection   | 600 cm                           | 600 cm                           |
| Max. fabric area  | 24 m <sup>2</sup>                | 24 m <sup>2</sup>                |
| Cassette size (height x depth)  | 139 x 228 mm                     | 139 x 228 mm                     |
| Crank drive   | ○                                | —                                |
| Motor drive   | ●                                | ●                                |
| Awning pitch  | at least 5°                      | at least 5°                      |
| Installation options  | p. 20 on                         | p. 20 on                         |
| LED lighting (separate spotlights)  | ○                                | ●                                |
| <b>Design</b>   |                                  |                                  |
| 47 standard frame colours   | ●                                | ●                                |
| Over 150 other RAL colours  | ○                                | ○                                |
| 9 trend colours   | ●                                | ●                                |
| Other textured colours  | ○                                | ○                                |
| weinor fabric collection  | ●                                | ●                                |
| Cassette and profile end caps in contrasting colour in 6 standard colours | ○                                | ○                                |
| <b>Accessories</b>  |                                  |                                  |
| For roof  | ○                                | ○                                |
| Fixing materials  | see p. 25                        | see p. 25                        |
| Remote control  | ○ see p. 11                      | ○ see p. 11                      |
| No remote:  | fully wired and ready to plug in | fully wired and ready to plug in |
| <b>Weather sensors</b>  |                                  |                                  |
| WeiTronic Aero-868 Solar sun and wind sensor                              | ○                                | ○                                |
| WeiTronic Aero-868 AC 230 sun and wind sensor                             | ○                                | ○                                |
| WeiTronic Sensero-868 AC 230 sun, wind and rain sensor                    | ○                                | ○                                |









## Fabrics – attractive, brilliant long-lasting colours

For an attractive awning you need a high-quality fabric. The 'colours by weinor®' collections provide a wide selection.

- solution-dyed to make them colour-fast
- stay beautiful thanks to dirt- and water-repellant nano-coating
- optional: wide range of collections by other manufacturers



Acrylic fabrics  
100 patterns

- high-quality acrylic
- proven for decades
- fabric width: 120 cm/240 cm



Polyester fabrics  
55 patterns

- innovative polyester quality
- high-stretch with memory effect®
- fabric width: 120 cm



## Wide range of frame colours – abundance of choices

weinor coats all of its products in its own workshop. This ensures that they have the best-possible colour tonality and identical gloss levels.

- 47 standard RAL frame colours, silk gloss (gloss level  $70 \pm 5\%$  when measured at a  $60^\circ$  angle)
- 9 scratchproof, resistant trend colours with a textured look
- over 150 special RAL colours

### 47 standard frame colours

|                            |                             |                        |                         |                                  |                            |                           |                             |                            |
|----------------------------|-----------------------------|------------------------|-------------------------|----------------------------------|----------------------------|---------------------------|-----------------------------|----------------------------|
|                            |                             |                        |                         |                                  |                            |                           |                             |                            |
| RAL 1002<br>Sandy yellow   | RAL 1003<br>Signal yellow   | RAL 1014<br>Ivory      | RAL 1015<br>Light ivory | RAL 1023<br>Traffic yellow       | RAL 1034<br>Pastel yellow  | RAL 2000<br>Yellow orange | RAL 2002<br>Vermilion       | RAL 2011<br>Deep orange    |
|                            |                             |                        |                         |                                  |                            |                           |                             |                            |
| RAL 3002<br>Carmine red    | RAL 3004<br>Magenta red     | RAL 3007<br>Black red  | RAL 4005<br>Blue lilac  | RAL 4006<br>Traffic purple       | RAL 5005<br>Signal blue    | RAL 5009<br>Azure blue    | RAL 5014<br>Pigeon blue     | RAL 5021<br>Water blue     |
|                            |                             |                        |                         |                                  |                            |                           |                             |                            |
| RAL 5022<br>Night blue     | RAL 5024<br>Pastel blue     | RAL 6005<br>Moss green | RAL 6009<br>Fir green   | RAL 6011<br>Reseda green         | RAL 6012<br>Black green    | RAL 7015<br>Slate grey    | RAL 7016<br>Anthracite grey | RAL 7021<br>Black grey     |
|                            |                             |                        |                         |                                  |                            |                           |                             |                            |
| RAL 7030<br>Stone grey     | RAL 7032<br>Pebble grey     | RAL 7035<br>Light grey | RAL 7039<br>Quartz grey | RAL 7040<br>Window grey          | weinor 7319<br>weinor grey | RAL 8001<br>Ochre brown   | RAL 8003<br>Clay brown      | RAL 8014<br>Sepia brown    |
|                            |                             |                        |                         |                                  |                            |                           |                             |                            |
| RAL 8016<br>Mahogany brown | RAL 8017<br>Chocolate brown | RAL 8019<br>Grey brown | RAL 8022<br>Black brown | weinor 8077<br>weinor dark brown | RAL 9001<br>Cream          | RAL 9005<br>Jet black     | RAL 9006<br>White aluminium | RAL 9007<br>Grey aluminium |
|                            |                             |                        |                         |                                  |                            |                           |                             |                            |
| RAL 9010<br>Pure white     | RAL 9016<br>Traffic white   |                        |                         |                                  |                            |                           |                             |                            |

### 9 trend colours

|                                 |  |                                     |                                      |  |  |  |  |  |
|---------------------------------|--|-------------------------------------|--------------------------------------|--|--|--|--|--|
|                                 |  |                                     |                                      |  |  |  |  |  |
| WT 29/10797<br>Approx. RAL 9010 | WT 29/50704<br>Approx. RAL 6009 metallic | WT 29/60740<br>Chestnut 04 metallic | WT 29/70786<br>Sparkling iron effect | WT 29/71289<br>Approx. RAL 7016 metallic | WT 29/80077<br>Approx. DB 703 metallic | WT 29/80081<br>Iron glimmer effect P 7 | WT 29/90146<br>Approx. RAL 9006 metallic | WT 29/90147<br>Approx. RAL 9007 metallic |

weinor is an eco-friendly company. To ensure compliance with high environmental standards, manufacturing processes and materials undergo regular testing by experts.

As a result of the ban on the use of heavy metals in powder coatings, paint manufacturers can no longer guarantee colour stability despite making every effort to do so. It therefore cannot be excluded that colours in general, and Fire Red (RAL 3000) in particular, may fade with time. For technical reasons, the colours may appear significantly different when printed.







## LED lighting – 30,000 hours of lighting require low energy consumption

Select LED components for top weinor quality:

- flush installation
- atmospheric light thanks to special glass lenses
- lighting remains on even when awning is retracted
- extremely energy-efficient
- lifetime of 30,000 hours
- dim to any level with the WeiTronic remote control
- easy to service: simply replace individual LED lights without uninstalling the awning

| Awning width | Number of separate LED spotlights |
|--------------|-----------------------------------|
| 151 – 164 cm | 2                                 |
| 165 – 219 cm | 3                                 |
| 220 – 274 cm | 4                                 |
| 275 – 329 cm | 5                                 |
| 330 – 384 cm | 6                                 |

| Awning width | Number of separate LED spotlights |
|--------------|-----------------------------------|
| 385 – 439 cm | 7                                 |
| 440 – 494 cm | 8                                 |
| 495 – 549 cm | 9                                 |
| 550 – 600 cm | 10                                |







Remoto 1M/5M

Remoto 10M

## WeiTronic UniLine – coordinated control for Sottezza, light and heating (optional)

The Sottezza motor comes with a fabric tensioning position as standard. This leaves the fabric taut in its final position.

- optional: with pre-programmed WeiTronic Remoto remote control
- handheld transmitters available with 1, 5 or 10 channels and display

### WeiTronic remote control

Heating system, Tempura Light bar systems



### WeiTronic Remoto handheld transmitter

- safe to operate on protected frequency (868 MHz)
- range of up to 100 m
- simpler than a TV remote, attractive, convenient design

### WeiTronic remote-controlled receiver

- various remote-controlled receivers depending on functions used
- for multi-panel units with multiple motors
- for coupled units with just one motor

| Product      | Fittings     | Remote-controlled receiver | Handheld transmitter |
|--------------|--------------|----------------------------|----------------------|
| Sottezza     | Awning motor | Combio-868 MA              | Remoto 1/5/10M       |
| Sottezza LED | + LED light  | Combio-868 MLED            | Remoto 5/10M         |

Requires WGM Sottezza with WeiTronic remote control, sensors require at least one Remoto 1M, 5M or 10M handheld transmitter

| Product      | Fittings     | Somfy RTS      | Somfy io       |
|--------------|--------------|----------------|----------------|
| Sottezza     | Awning motor | ●              | ●              |
| Sottezza LED | + LED light  | ● Not dimmable | ● Not dimmable |

● available



WeiTronic Sensero-868 AC 230

## Sun, wind and rain sensors – automatically protect your product and prevent excess heat (optional)

The WeiTronic series remote sensors automatically extend the awning when the sun shines and reliably retract it in the wind or rain.

Available types:

- WeiTronic Sensero-868 AC 230 sun, wind and rain sensor
- WeiTronic Aero-868 AC 230 sun, wind and rain sensor (or solar-run WeiTronic Aero-868 solar)



## Tempura Universal heating system, high-performance level (optional)

The energy-efficient Tempura infrared heating system has an impressive heating capacity of over 1,500 watt in a tiny housing.

- instant heat: no warm-up time
- turn as required for targeted warmth
- operate and dim using WeiTronic remote control
- splash protection
- comes in 47 standard frame colours plus 9 scratchproof, resistant trend colours with a smart, textured look
- option: 150 special RAL colours
- universal bracket makes it easy to retrofit
- TÜV tested





## Manual operation

If the Sottezza is installed in a confined space, it can optionally be extended and retracted using a gear box and hand-operated crank.

Maximum dimensions  
400 cm wide  
400 cm diagonal

The fabric can then be tightened by manually retracting the awning slightly using the hand-operated crank.

The resulting fabric sag does not affect the operation of the system.



## Coupling

Beneath very wide roofs, two separate single-panel units can be coupled and operated using just one motor.

- both panels can be opened at once
- two-panel units fitted with a motor as standard
- if both sections are to be operated separately, this requires two motors

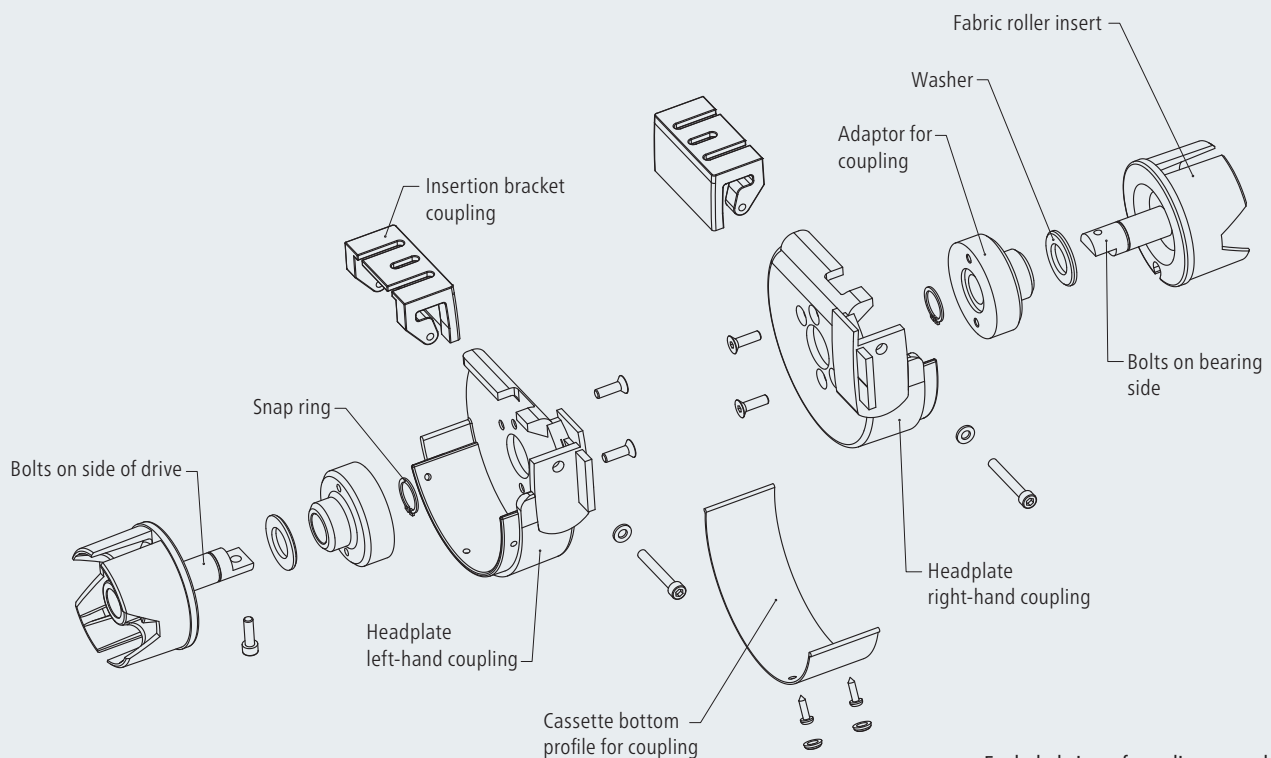

Exploded view of coupling assembly

## Cross-section and dimensions of Sottezza with roof

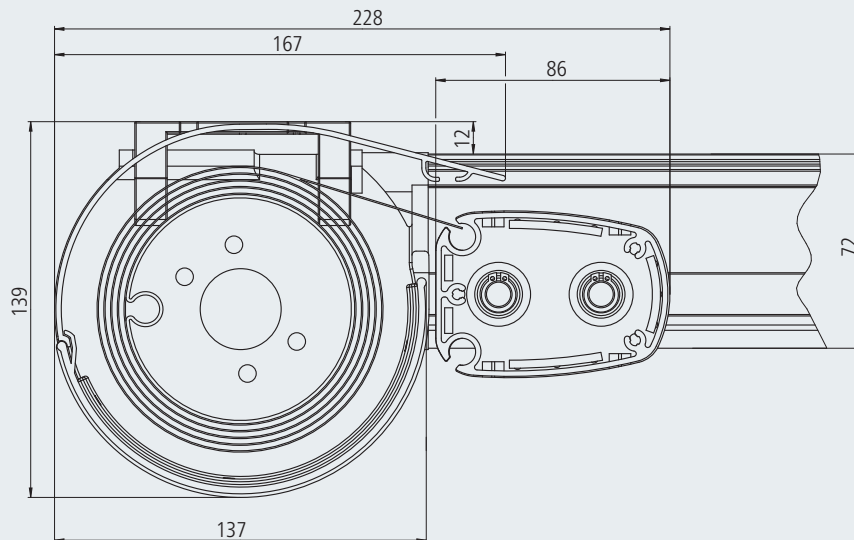

Note: the Sottezza can also be delivered without a cassette bottom profile, with the same dimensions as the version with a cassette bottom profile.

## Cross-section and dimensions of Sottezza without roof

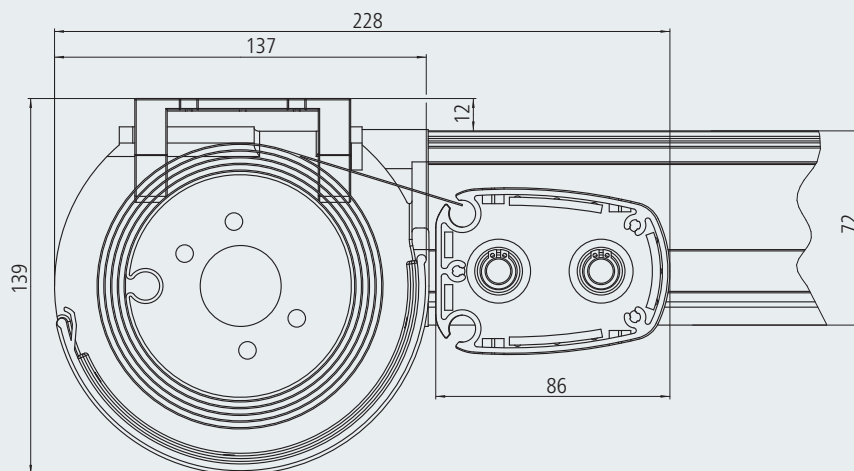

## Cross-section and dimensions of Sottezza LED without roof

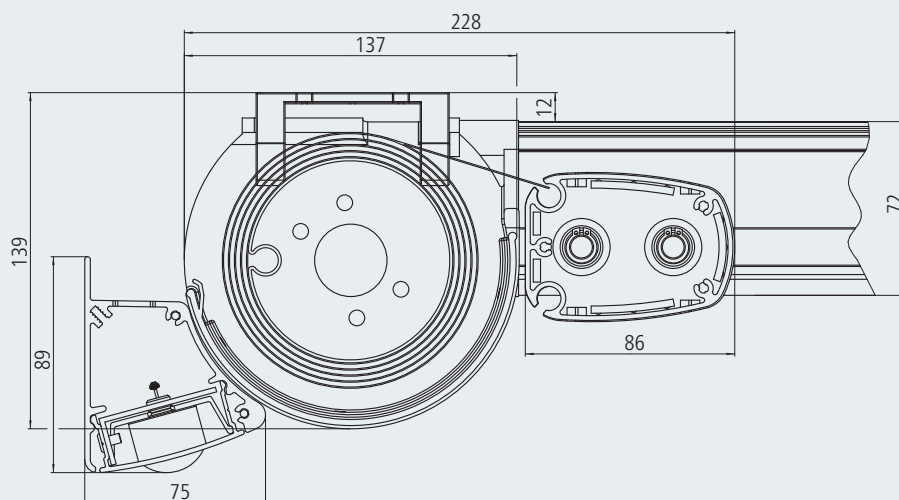



## Using the support wires

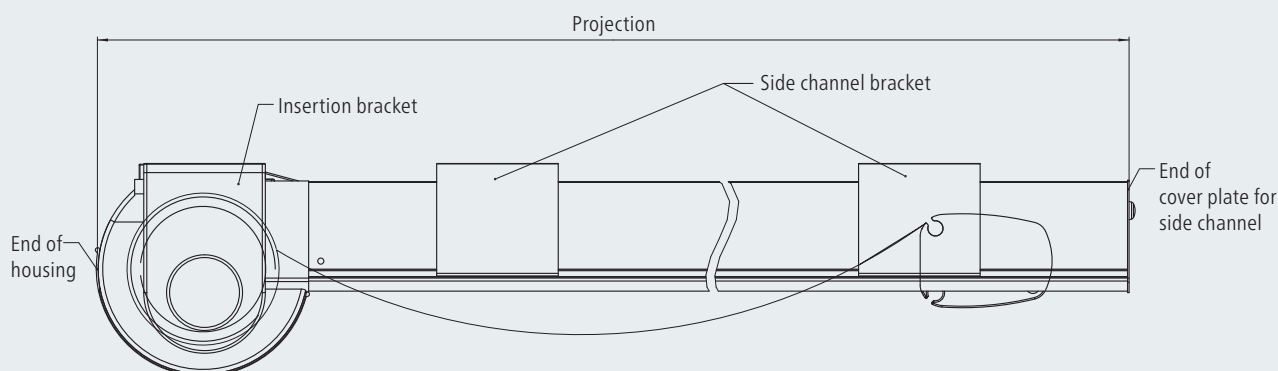

Support wires are used to stop the fabric sagging. There may be 15 cm of sag in the centre even when support wires are used.

### Measuring the support wires:

- after pull-back, side edges of fabric should be at most 3 cm beneath the lower edge of the side channels  
(pull-back: motor automatically tensions the fabric by pulling it back about 2 cm after the awning has opened)

### Position of support wire brackets:

- near the side channel bracket to make it easier to tension wires
- evenly distributed across the diagonal at regular intervals

### Fitting the support wires:

- fit on site as high up as possible in the slotted hole on the support wire bracket
- effect: front rail extends across support wire without friction

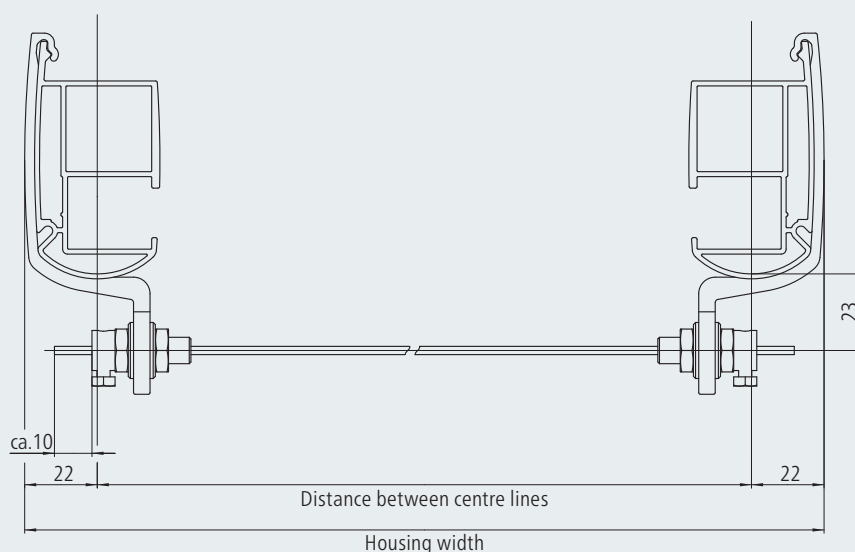

## Standard number of support wires

The standard number of support wires can be determined as follows:

1. Check whether the measurements required are feasible
2. Refer to table on right for standard number
3. For multi-panel units: add support wires per panel to arrive at the total
4. For coupled units with different-sized panels: number of support wires is based on the largest unit section with the most support wires

The following table shows the minimum number of support wires depending on

- projection
- housing width

The indicated number of support wires is included as standard in the awning price.

For the number and price of additional support wires, please refer to the current weinor price list.

| Housing width in cm | Projection in cm |           |           |           |           |           |           |           |           |
|---------------------|------------------|-----------|-----------|-----------|-----------|-----------|-----------|-----------|-----------|
|                     | up to 200        | 201 – 250 | 251 – 300 | 301 – 350 | 351 – 400 | 401 – 450 | 451 – 500 | 501 – 550 | 551 – 600 |
| up to 400           | –                | –         | –         | –         | 1         | 1         | 2         | 2         | 3         |

– no spacer wire necessary

## All views of flat single-panel unit

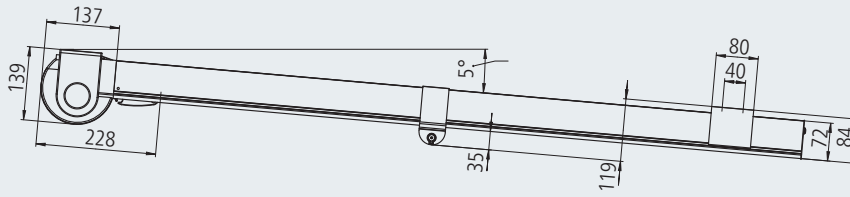

Side view of Sottezza

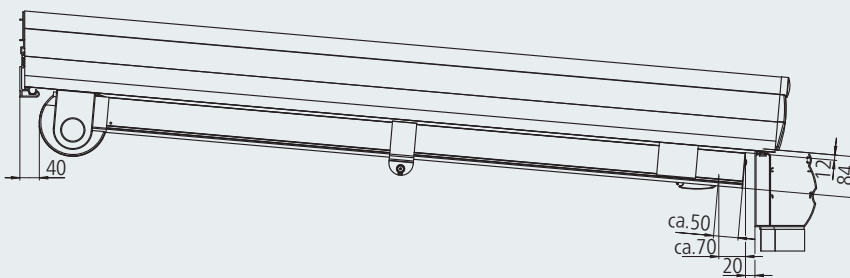

Side view of Sottezza  
beneath Terrazza

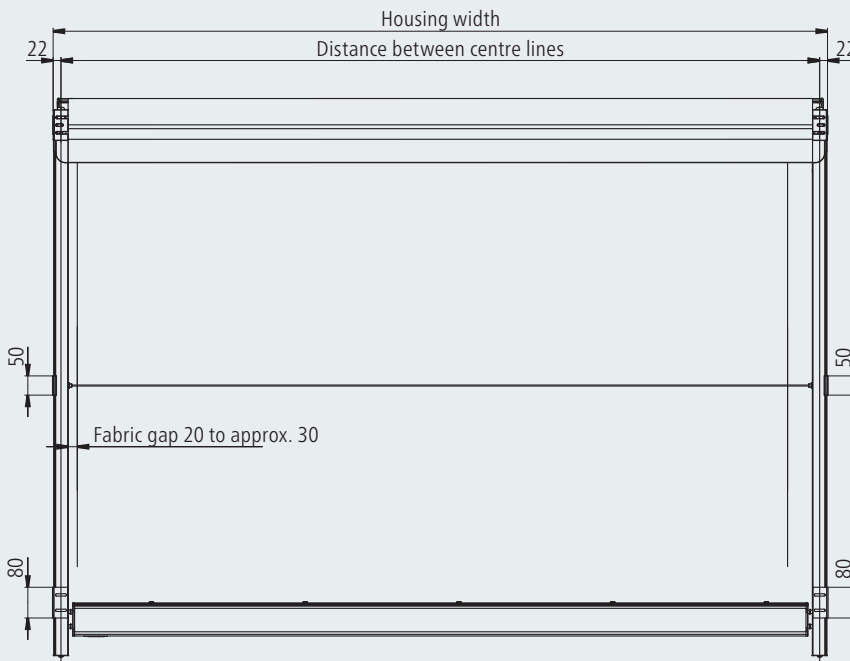

Top view of Sottezza



## Front view of Sottezza fitted to Terrazza

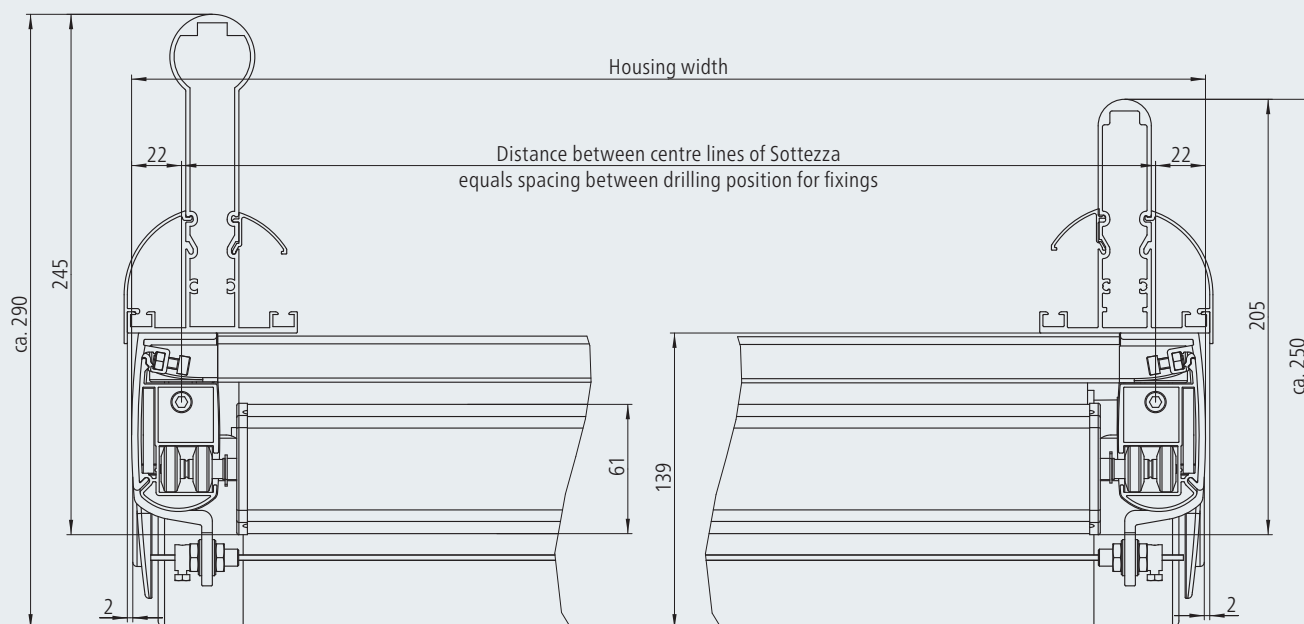
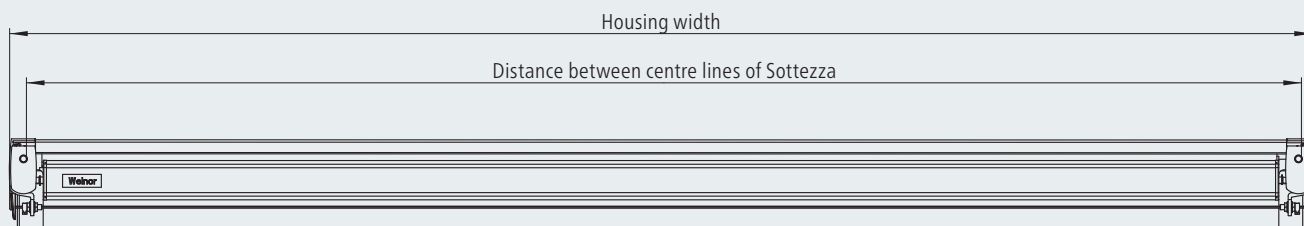

## Model designations/determining dimensions

Model designation, e.g.:

**Sottezza 0-1-1**

Code:

0 = number of curves

1 = number of panels

1 = number of motors

### Determining dimensions

**Projection:** end of housing to end of cover plate for side channel

#### Housing width = panel width

End of housing to end of housing  
for a single-panel unit or  
a unit section (= panel)

#### Total housing width = unit width

End of housing to end of housing for  
several unit sections (= panels)

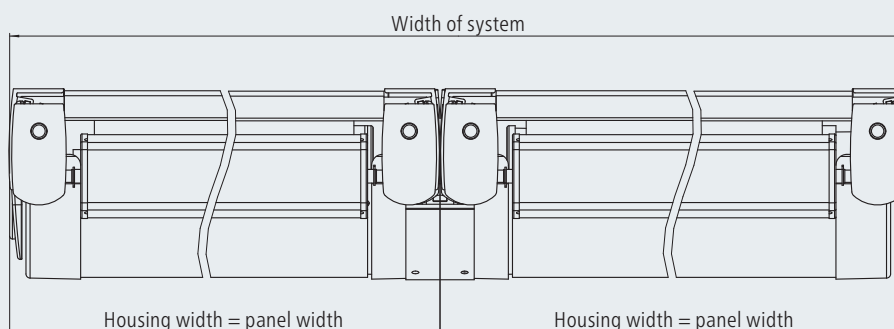
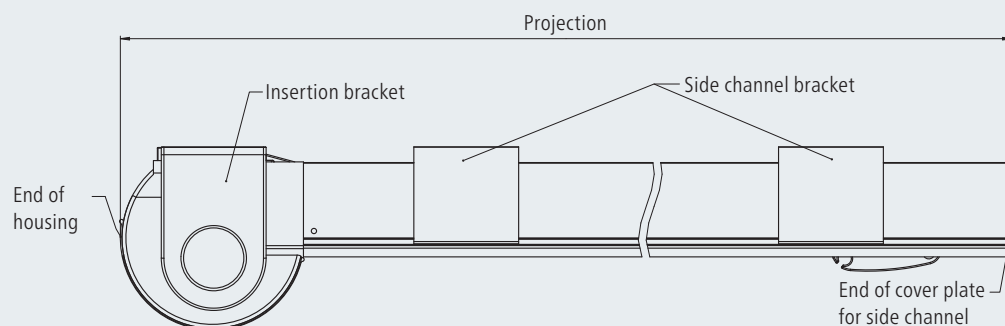
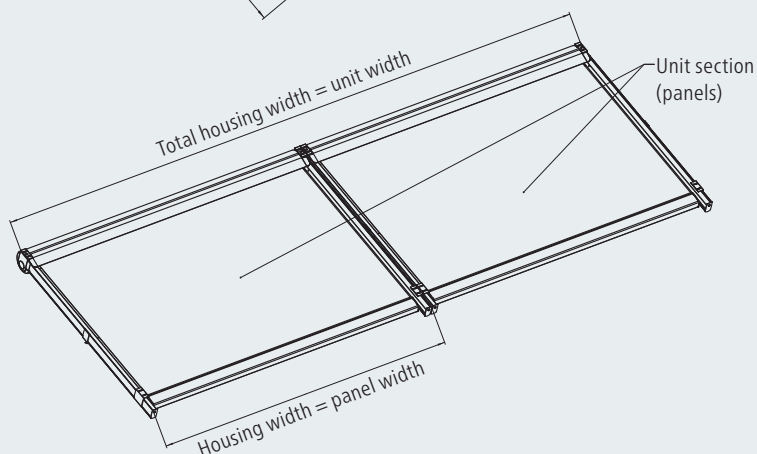
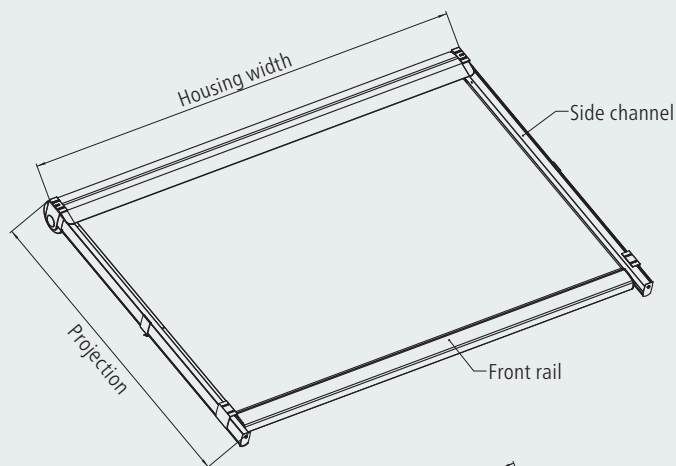

| Panels | Type:<br>WGM<br>Sottezza | No. of<br>panels | No. of<br>motors | No. of<br>drives | Max.<br>projection in cm | Housing width<br>= min.-max.<br>panel width in cm | Total housing width<br>= min.-max.<br>width of system in cm |
|--------|--------------------------|------------------|------------------|------------------|--------------------------|---|---|
|        | 0-1-0                    | 1                | 0                | 1                | 400                      | 80 – 400  |   |
|        | 0-1-1                    | 1                | 1                | 0                | 600                      | 80 – 600  |   |
|        | 0-2-1                    | 2                | 1                | 0                | 600                      | 90 – 500  | 180 – 1.000   |



## Type of fixings/no. of fixing points

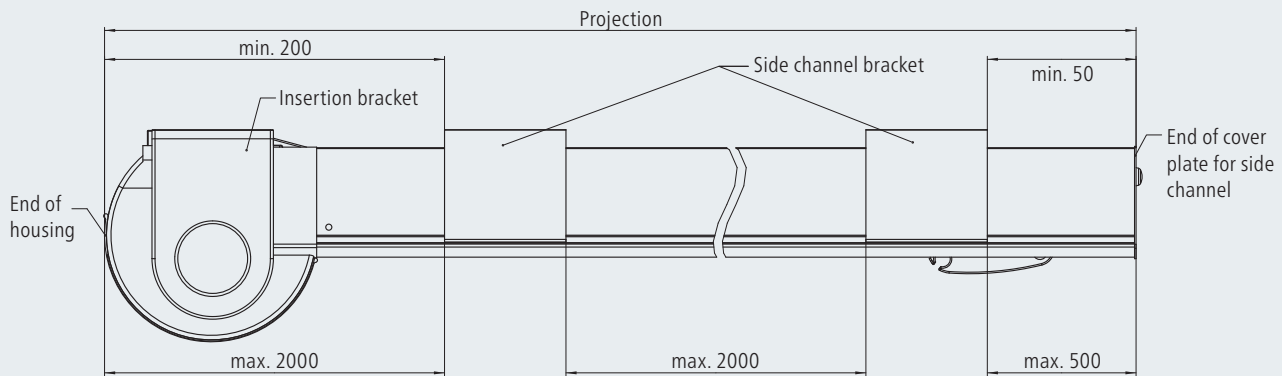

Important measurements for bracket position  
(in mm)

### Standard fixing type

Screws point upwards, i.e. from beneath the roof support or other supports above them

### No. of fixing points

The table opposite shows the minimum number of fixing points for a Terrazza or Vivienda patio roof (incl. 2 insertion brackets per section/panel)

The indicated number of fixings is included in the delivery.

When the Sottezza is installed beneath another roof, additional fixings may be required.

| Panels | Type:<br>WGM<br>Sottezza | Projection<br>in cm<br>up to 150 | Projection<br>in cm<br>151 – 250 | Projection<br>in cm<br>251 – 350 | Projection<br>in cm<br>351 – 400 |
|--------|--------------------------|----------------------------------|----------------------------------|----------------------------------|----------------------------------|
|        | 0-1-0                    | 4                                | 4                                | 6                                | 6                                |
|        | 0-1-1                    |                                  |                                  |                                  |                                  |
|        | 0-2-1                    | 8                                | 8                                | 12                               | 12                               |

Additional support wires and fixings recommended in case of

- strong winds
- weak roof construction

Units with Soltis® fabrics can only be delivered in certain sizes.

The set does not include material required to retrofit a Sottezza to a pre-built roof construction.

Please refer to current weinor price list.

## Using the alcove angle bracket

The distance between centre lines and the housing widths below are for Sottezza units with one panel. They produce the total distance between centre lines and the total

housing widths for coupled units up to a total width of 1,000 cm. In the case of coupled and multi-panel units, special brackets are required to compensate for the difference

between the alcove angle bracket and the lower edge of the roof support.

### Installing the alcove angle bracket

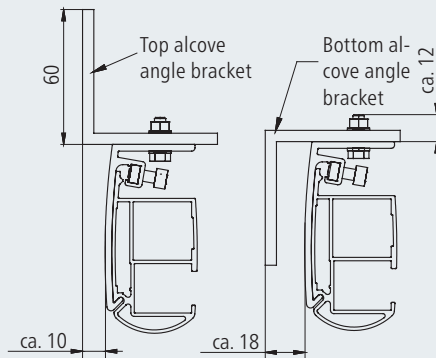

#### Legend:

**A** = distance between centre lines of Sottezza  
(distance from centre of one side channel to  
centre of the other)

**K** = housing width

**BN** = width of alcove

Figures are in mm

### Any roof with alcove angle brackets

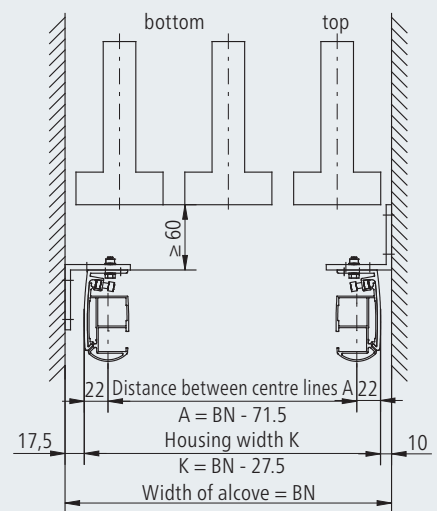
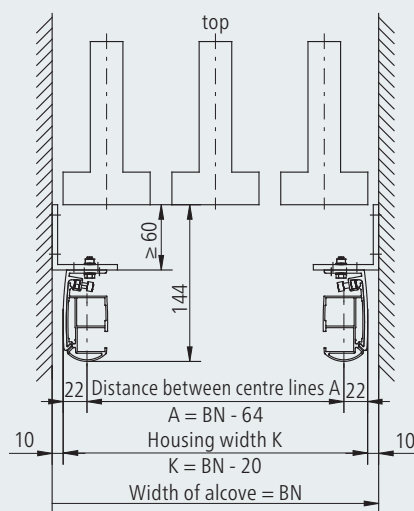
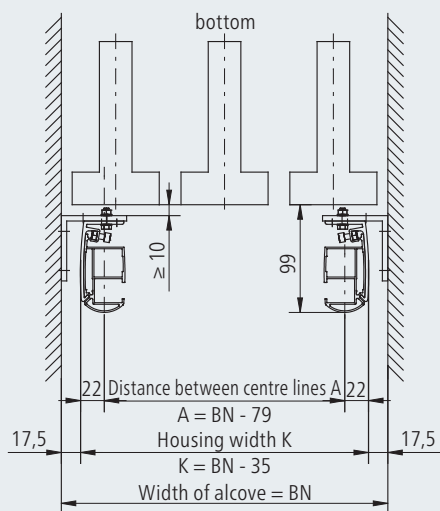

### Any roof with vertical elements at the side

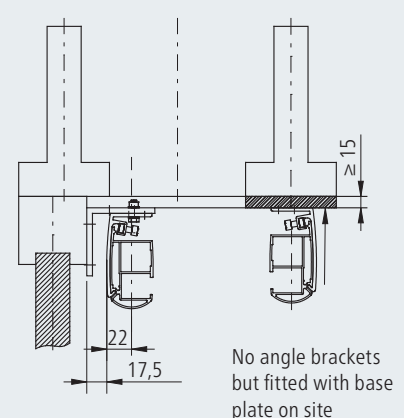
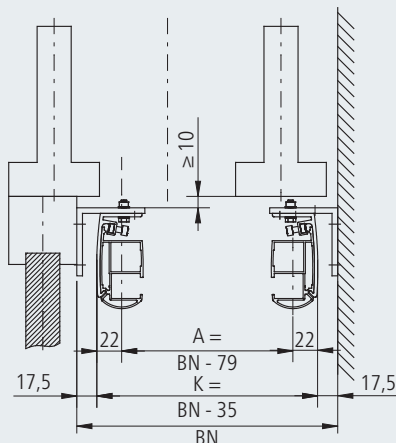
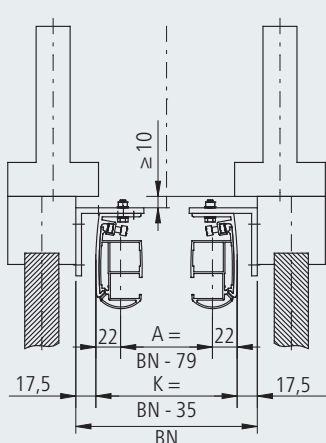



## Standard installation types: Sottezza/LED beneath Terrazza patio roof

### Type 1:

Terrazza patio roof  
(unlimited)  
with a Sottezza

#### Single-panel unit

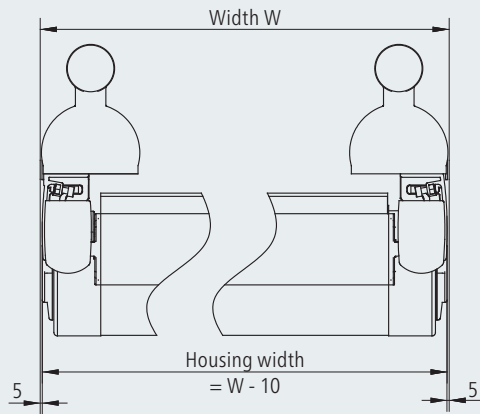

#### Two-panel unit or two single-panel units

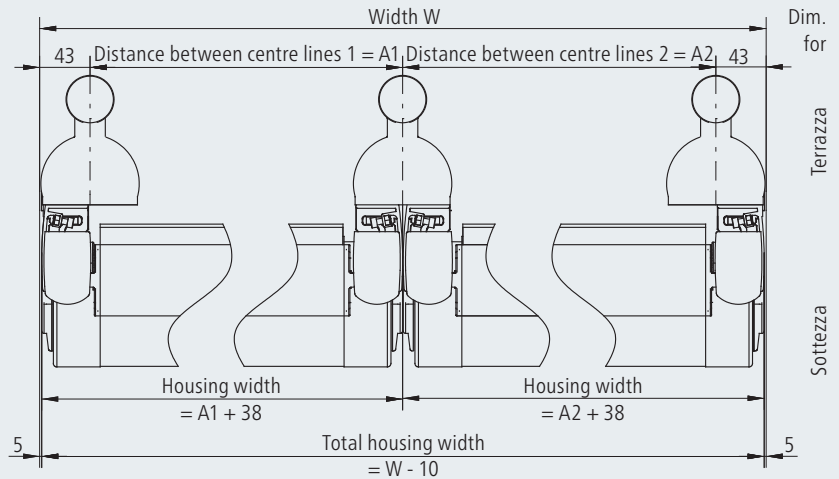

### Type 2:

Terrazza patio roof  
(limited on one side by a wall)  
with a Sottezza

#### Single-panel unit

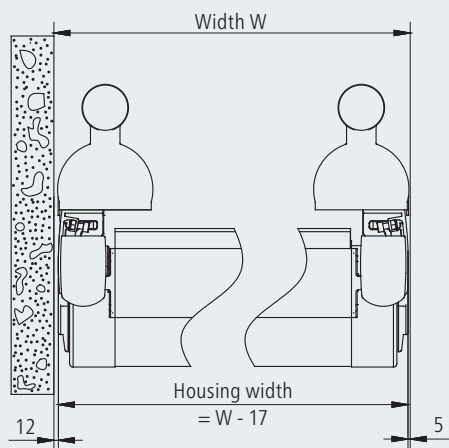

#### Two-panel unit or two single-panel units

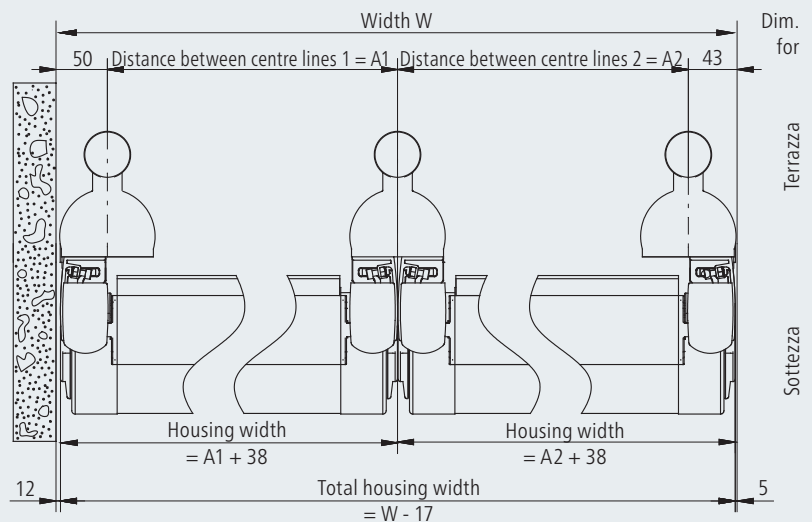

## Standard installation types: Sottezza/LED on Terrazza patio roof

### Type 3:

Terrazza patio roof

(limited by walls on both sides) with a Sottezza

#### Single-panel unit

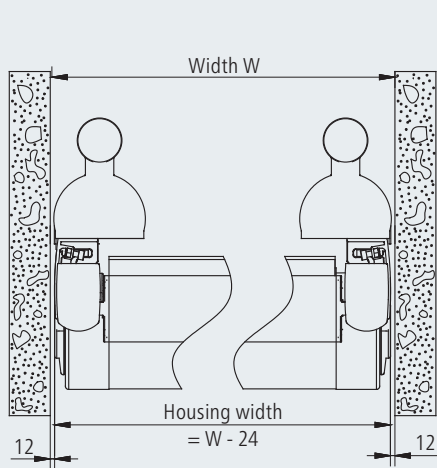

#### Two-panel unit or two single-panel units

$$A1 = W - 100 - A2; A2 = W - 100 - A1$$

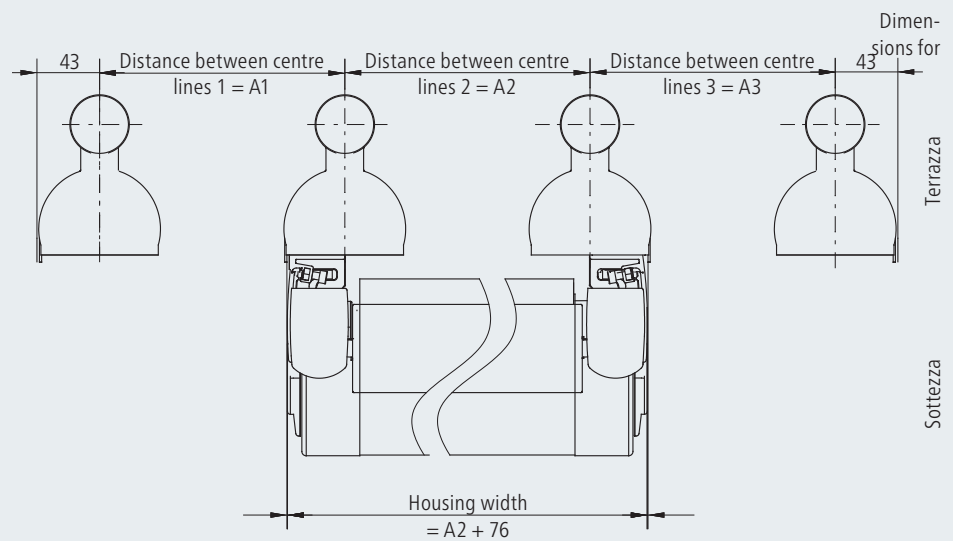
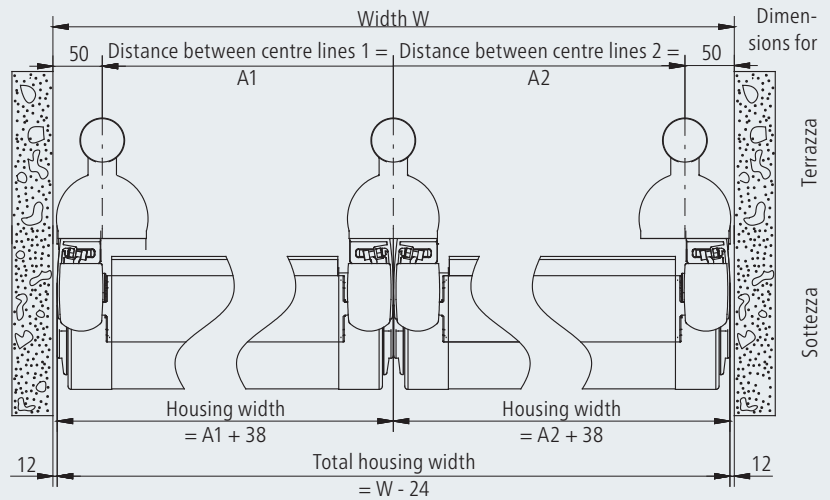

#### Standard situation on delivery

The drawing on the right shows:

- position of bracket for side channel (for central fitting)
- total casing width for Sottezza

If a different bracket position is preferred:

- indicate this specifically when ordering
- bracket provision not possible

When installing other Sottezzas at a later time:

- total casing width of all Sottezza units = distance between centre lines of Terrazza or Vivienda roof



## Standard bracket position for Sottezza on Terrazza patio roof with optional bracket provision

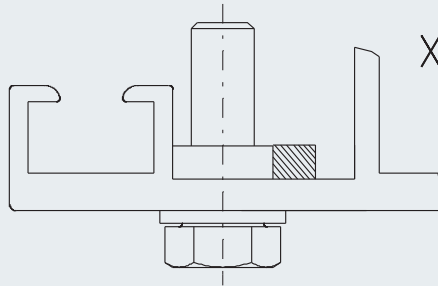
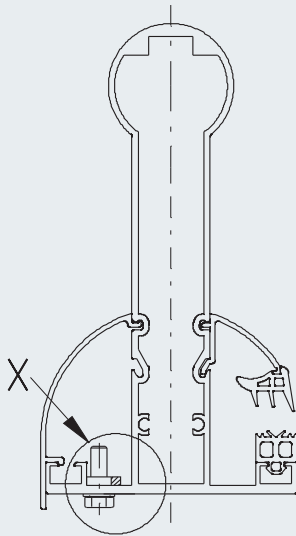

**Terrazza option bracket provision:**  
Can only be provided when standard fixings are attached in adjacent positions.

- screws are secured in the roof brackets using washers and nuts
- screws are glued in the roof

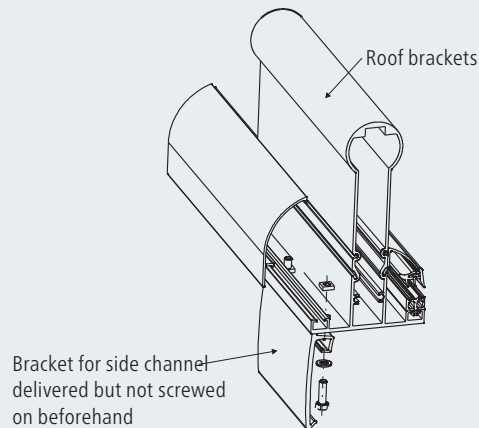

**Sottezza delivered with:**

- side channel brackets
- insertion brackets for fixing to prepared roof brackets

All fixings are delivered as described in the standards.

Bracket for side channel

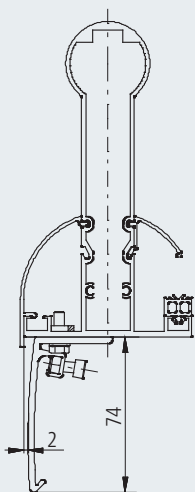

Insertion bracket

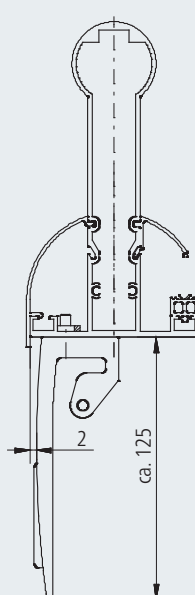

Bracket for side channel

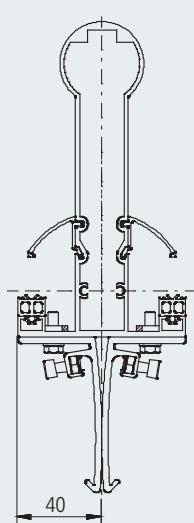

Standard insertion brackets (multi-section units)

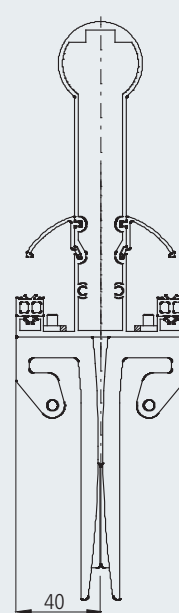

Coupling insertion brackets

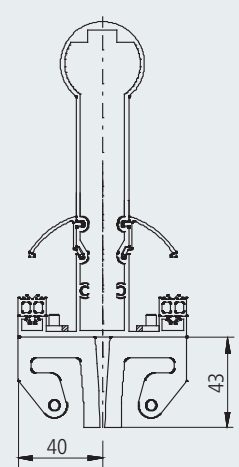

## Example installation: WeiTop Terrazza with Sottezza and Aruba Carré/Round

### Benefits of using an Aruba

- vertical sun protection at the front
- does not reduce clearance height
- no gap between the post and the fabric

### Options:

- Aruba Carré/Round with rail guide
- Aruba Carré/Round with rope guide

### Conditions:

- guide rail must be screwed into gutter: no steel at location of screw
- Aruba guide rails must be attached to patio roof post: 4 x 2.5 mm spacer rings required per fixing point
- coupled/multi-panel units: two rails required on one post

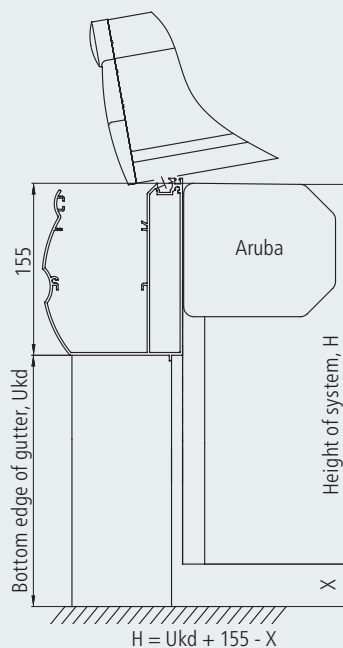

### Legend:

- BA = width of Aruba unit
- BT = width of Terrazza
- Ukd = bottom edge of gutter
- X = any value
- H = height of system

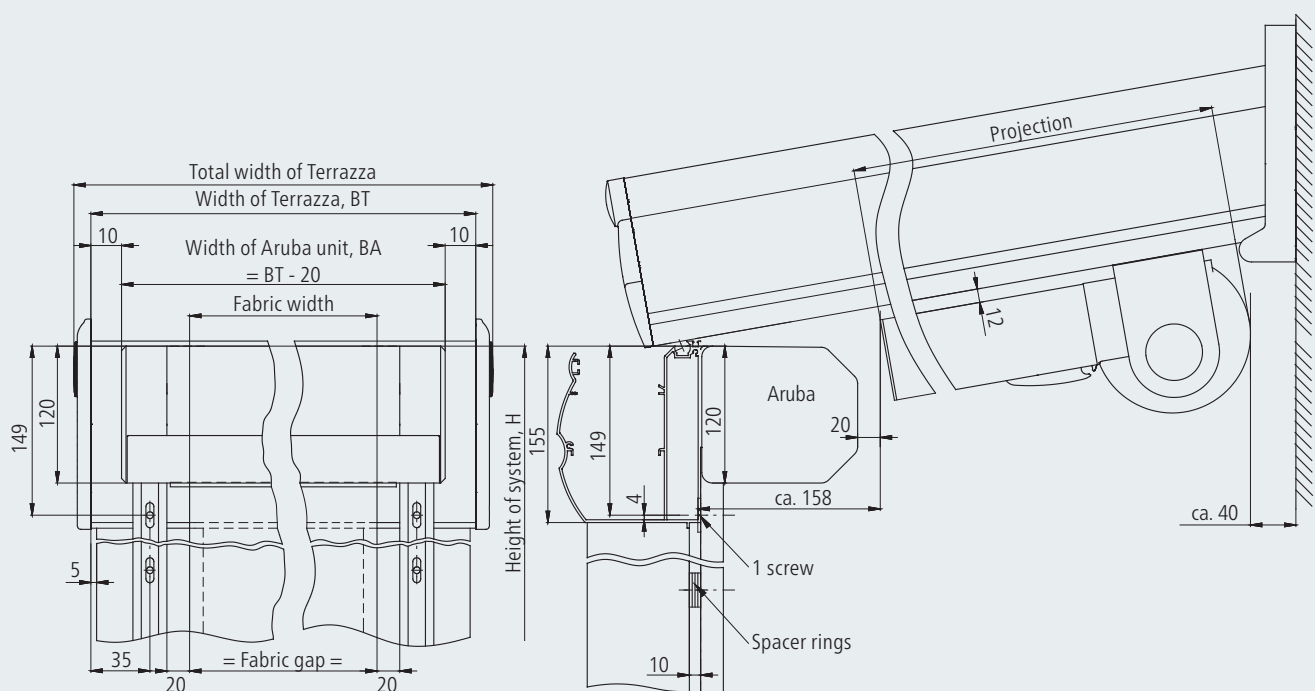

## Standard fixing materials



### Insertion bracket

Two insertion brackets are required for each Sottezza/LED or for each unit section

Includes:

- socket head cap screw  
DIN 912-M6x45-A2
- washer, DIN 125-6.4-A2

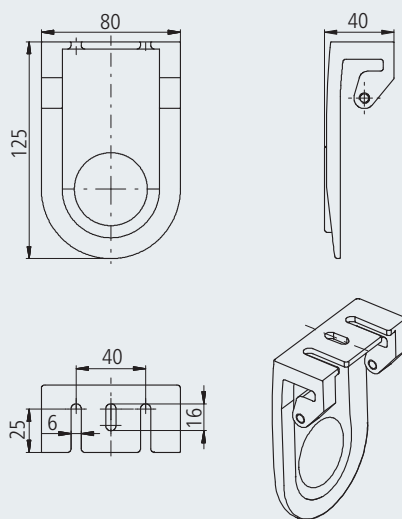

Insertion bracket

### The insertion bracket coupling

At the joint where unit sections are connected.

Includes:

- socket head cap screw  
DIN 912-M6x45-A2
- washer: DIN 125-6.4-A2

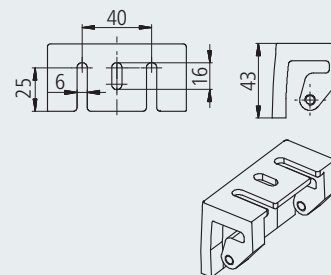

Insertion bracket coupling

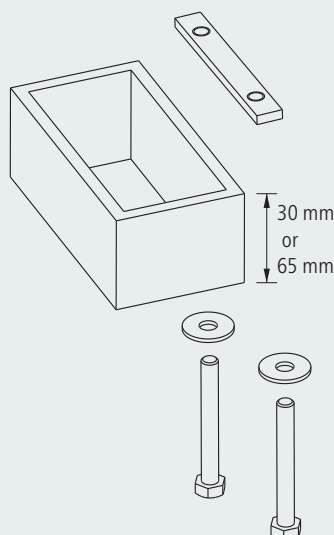

### Installation with a distance bar

When attaching the Sottezza to a Terrazza patio roof with LED Design and/or roof vents, the L = 30 mm or L = 65 mm distance bar (as appropriate) must be used to separate them correctly.

1 set comprising:

- distance bar for installation, L 30 mm or L 65 mm (1x)
- clamping slider, 60x8x3 (1x)
- washer, DIN 125-5.3-A2 (2x)
- hexagon head set screw, DIN 933-M5x45 and/or DIN 933-M5x80 (2x)

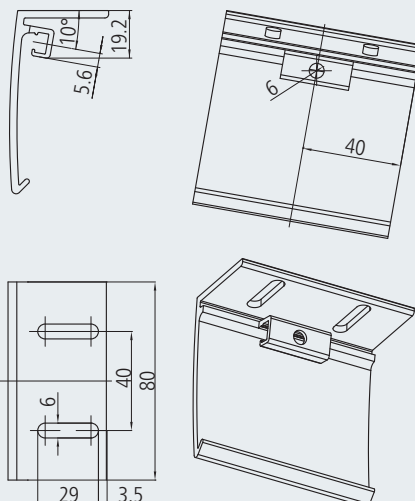
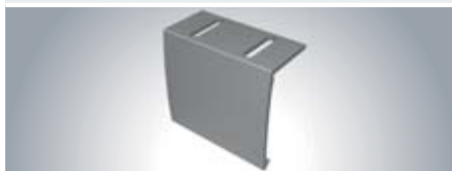

### Side channel bracket

When attaching to a Terrazza patio roof, use the current weinor price list to find the standard number of side channel brackets.

When attaching the Sottezza/LED to another roof, more side channel brackets may be required.

Includes:

- socket head cap screw  
DIN 912-M5x12-A2
- hexagon nut, DIN 934-M5-A2



## Standard fixing materials

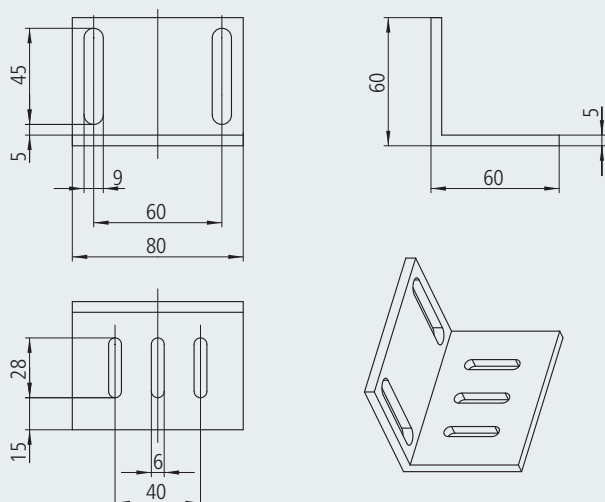

### Alcove angle bracket

The angle bracket is required for lateral fixing to walls, in alcoves or to vertical elements.

Includes screws to fasten the insertion bracket or the bracket for the side channel.

- hexagon head set screw, DIN 931-M5x16-A2 3x
- hexagon nut, DIN 985-M5-A2 3x
- washers, DIN 125-5.3-A2

Screws for fixing to Terrazza patio roof (standard positions)

1 set comprising:

- hexagon head set screw DIN 933-M5x16-A2 10x
- square nut, DIN 562-M5-A2 10x
- washers, DIN 125-5.3-A2 10x

## Special fixing materials

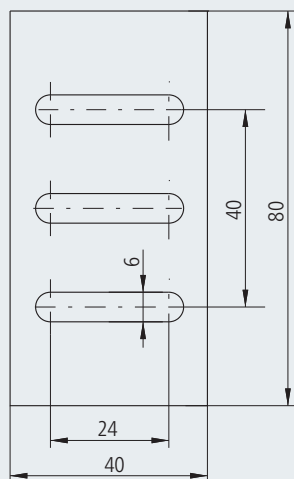

The fixing materials listed here can be used in various installation scenarios.

It is particularly practical to use fixing materials as padding or for lateral offsetting when fixing to other roofs, i.e. not to a weinor Terrazza or Vivienda roof or with coupled or multi-panel units.

### Base plate

- 5 mm thick
- place under the bracket for the side channel or the insertion bracket

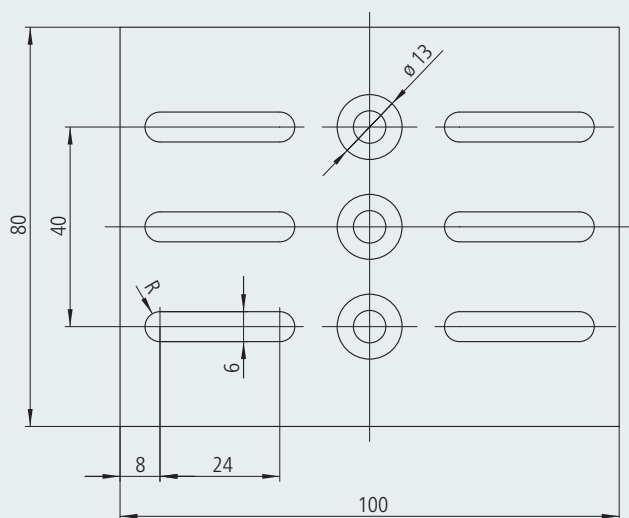

### Fixing plate

- place under the bracket for the side channel or the insertion bracket
- for laterally offsetting fixings
- for narrow roof supports

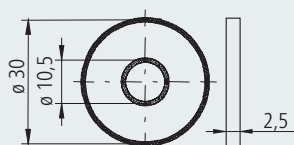

### Spacer ring

- place under the bracket for the side channel or the insertion bracket
- only comes in sets of 10

## Examples of installation with custom fixing materials

The two examples below show how special fixing materials are used. The right fixing materials must be used to suit the specific architecture and type of shading required.

- spacer rings can be fastened underneath the insertion brackets on the right-hand side.
- as the roof support is very narrow, the screws at the joint are positioned to its side.

- when the roof support is wide at the joint, screws are inserted straight into the roof support.

### Example 1

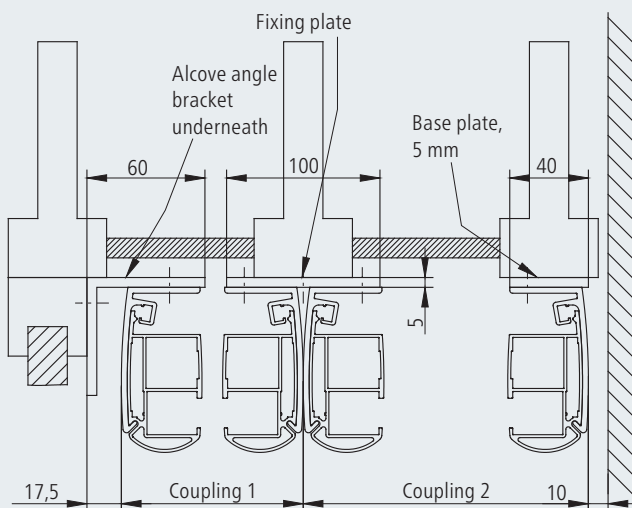

#### Sottezza 0-2-1 fixed to roof, with vertical element at side

- the fixing plate on the roof support must be fixed in place using upright screws or counter-sunk rivets

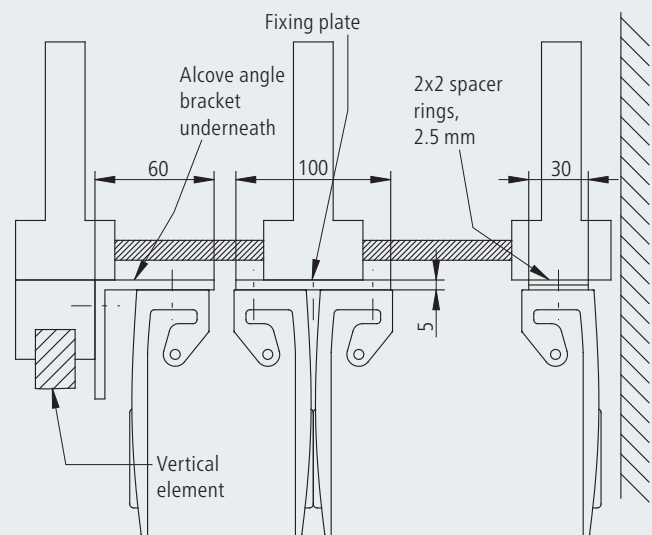

- due to the side fixing on the vertical elements, all fixings are 5 mm lower, so the fixings on the joints and on the right-hand side need 5 mm of padding

### Example 2

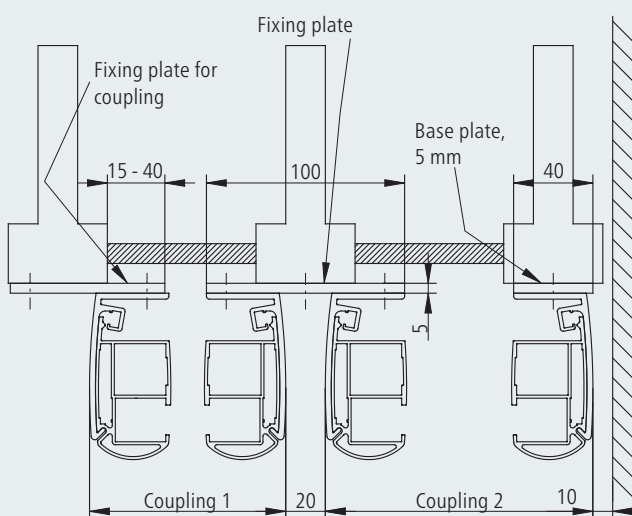

#### Sottezza fixing with offset at side

- due to the offset at the side, all fixings are 5 mm lower down and so they require 5 mm of padding at the joint and on the right-hand side

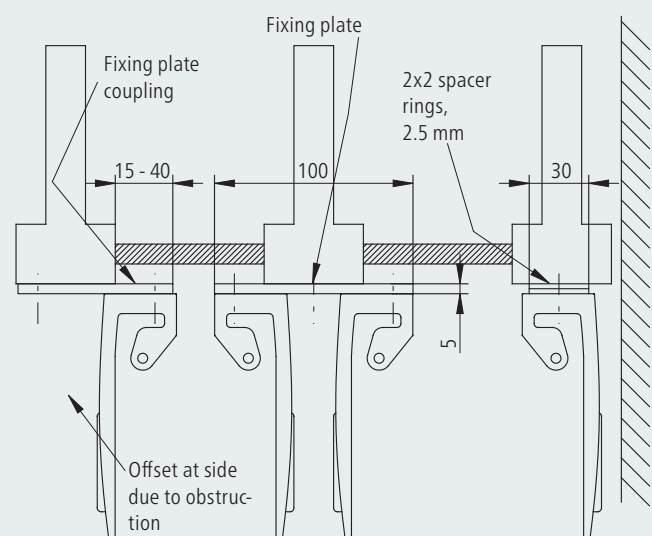

- the fixing plate on the roof support can be screwed in place with normal screws as long as there is enough space between the brackets

## Awnings



Awning



Awning with Valance Plus and Tempura



Awning with Valance Plus and Paravento



Premium quality  
Made in Germany

## Textile awning with posts



PergoTex and Tempura



Textile patio roof Plaza Home and Paravento

# Customised, systemised solutions

## Patio roof and Glasoase®



Glasoase® with conservatory awning and all-glass elements



Patio roof with SUPER LITE fixed glazing



Terrazza patio roof with Sottezza sun protection



Plaza Pro textile patio roof with Paravento and VertiTex

| Patent no |         |           |         |
|-----------|---------|-----------|---------|
| EP1310609 | 1541776 | EP0916781 | 0994221 |
| 1403442   | 2072709 | EP0959195 | 1206609 |
| 1382770   | 0745742 | EP0942114 | 1099808 |

Last revised: May 2013

We reserve the right to make technical changes. For technical reasons, the colours may appear slightly different when printed.